

## Groove Type



Groove type is held into a holder with a spring clip or pin. This pin is made of spring steel, and is designed to withstand impact forces.

Applications include:

- All air impact markers
- HG Series Hand holders
- Custom holders



Groove type comes in a variety of standard configurations: CMG, CMC and CMV. Custom sizes can be ordered by providing the blank information (see page 25).

Reverse Groove type is the same as the standard, but with the groove located at the top of the character. Denote reverse groove option as follows: CMGR, CMVR, CMCR.



**Multi-Character stamps** are easily ordered by extending the part number to include the "L" logo segment prefix and "C#" denoting the number of characters as the suffix.

Example: LCMG13C5-XXXXX  
(XXXXX are the characters required on the stamp.)

The height (B) and the length (C) of the stamp will remain the same. The width of the stamp (A) will be the single character width multiplied by the number of characters on the stamp.

## Groove Type Styles

### Groove Style CMG Series

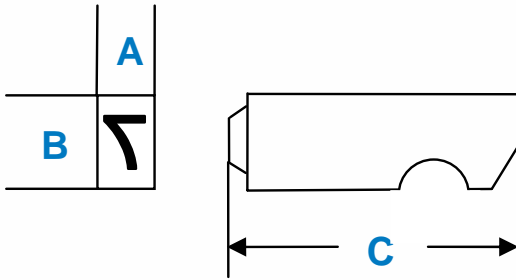

Char Size	A	B	C	Catalog No.
1/32	1/16	1/4	7/8	CMG03-
1/16	1/16	1/4		CMG06-
3/32	3/32	1/4		CMG09-
1/8	1/8	1/4		CMG13-
5/32	3/16	1/4		CMG16-
5/32	3/16	5/16		CMG16W-
5/32	5/32	1/4		CMG16N-
3/16	3/16	5/16		CMG19-
1/4	1/4	3/8		CMG25-

### Custom Style CMV Series

Char Size	A	B	C	Catalog No.
1/32	1/16	1/4	7/8	CMV03-
1/16	1/16	1/4		CMV06-
3/32	3/32	1/4		CMV09-
1/8	1/8	1/4		CMV13-

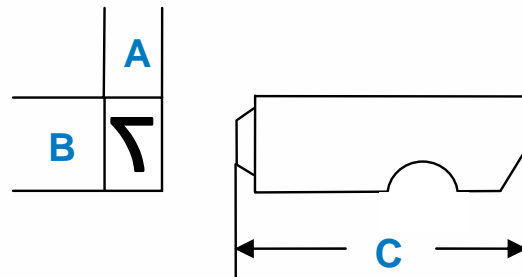

### Custom Style CMC Series

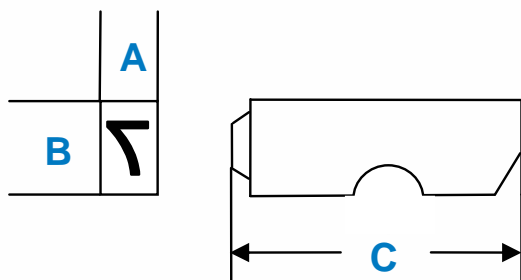

Char Size	A	B	C	Catalog No.
1/32	1/16	1/4	1 1/4	CMC03-
1/16	1/16	1/4		CMC06-
3/32	3/32	1/4		CMC09-
1/8	1/8	1/4		CMC13-
5/32	3/16	5/16		CMC16-
3/16	3/16	5/16		CMC19-
1/4	1/4	3/8		CMC25-